

George Bowerman

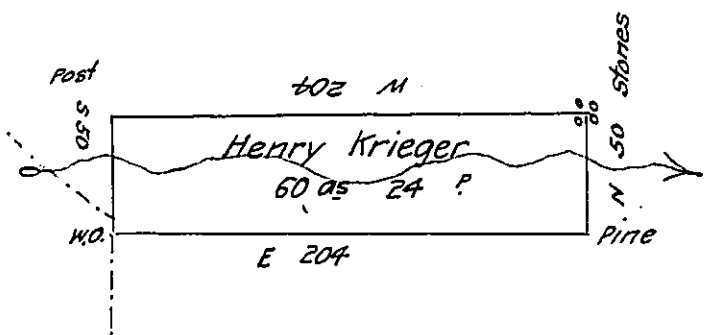

UNKNOWN

Land

A Draught of a Tract of Land situate in Penns Township in the County of Northumberland Surveyed the 23rd day of March 1793 for Henry Krieger in pursuance of his Warrant bearing date the 7th day of September 1773 Containing Sixty acres and twenty four Perches & allowance &c.

Pr

To Daniel Brodhead Esquire
Surveyor General of Pennsylv^a

Frd⁷ Evans D.S.

IN TESTIMONY that the above is a copy of the original remaining on file in the Department of Internal Affairs of Pennsylvania, made conformably to an Act of Assembly approved the 16th day of February, 1833, I have hereunto set my Hand and caused the Seal of said Department to be affixed at Harrisburg, this thirty first day of July 1905

Isaac R. Brown
Secretary of Internal Affairs.